

Smart Door Lock User Manual (Vertical Inner-body)

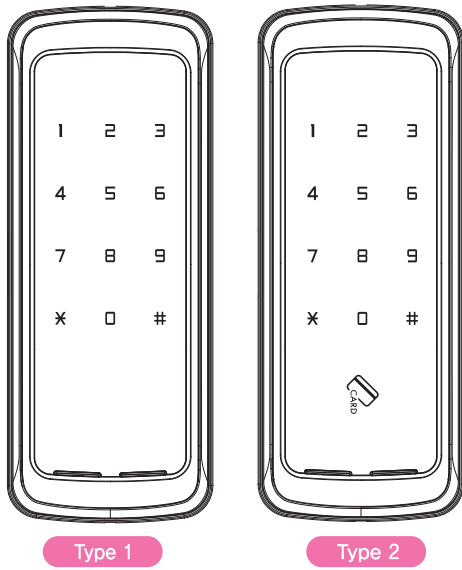

CAUTION
As this is a keyless digital door lock, damage may occur to parts of the dead lock system if it is not used according to the manual. Users should be fully aware of the manual and how to operate this product.

- This manual may change without notice in case of product improvement.
- Product specifications are subject to change without prior notice.
- This manual should not be edited or changed without manufacturer's permission.

1

Safety precautions

Warning The precautionary measures are for the safety of the user, for the prevention of property damage, and for the avoidance of any inconveniences due to an accident. These must be read and followed properly.

- Do not disassemble or alter the lock.
- Do not install where the distance over 5mm between the door and door frame.
- Please do not expose the password and change the password in regularly.
- Batteries should not be exposed directly to heat sources or flames, or submerged in water, because they may leak or explode, resulting in severe damage. Please do not use damaged batteries.
- Do not press using sharp tools or press numeric button excessively.
- Make sure the door is completely locked when going out.
- Place the batteries carefully and correctly according to their polarity (+/-). If the batteries are inserted in a wrong way, differently from the indicated direction or polarity, leakage or rupture could occur. Pay attention to it.
- Please do not mix old with new batteries or use different types. Always use new alkaline batteries.
- Do not clean the product with flammable materials such as alcohol, benzene or thinners. Such materials may damage the surface or cause a fire.
- Replace the current batteries with new ones within 1 week after the battery replacement notification melody sounded off for the first time.

Product Composition

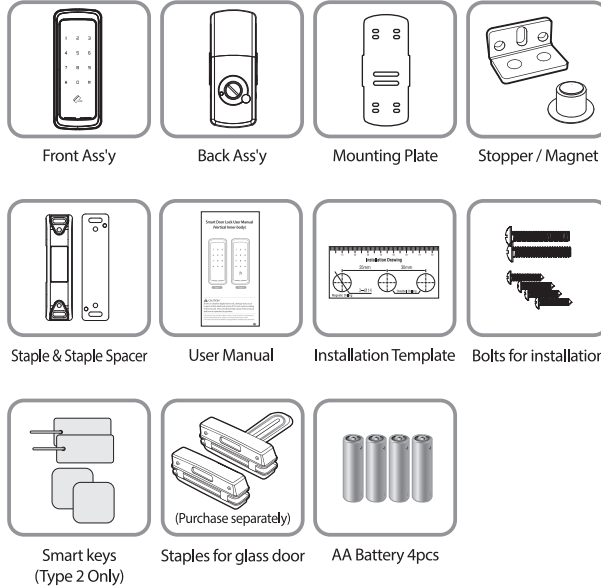

Name of parts (Front Ass'y)

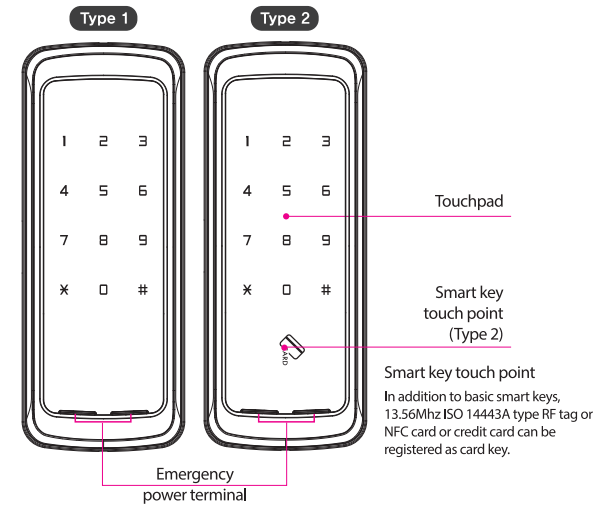

Name of parts (Back Ass'y)

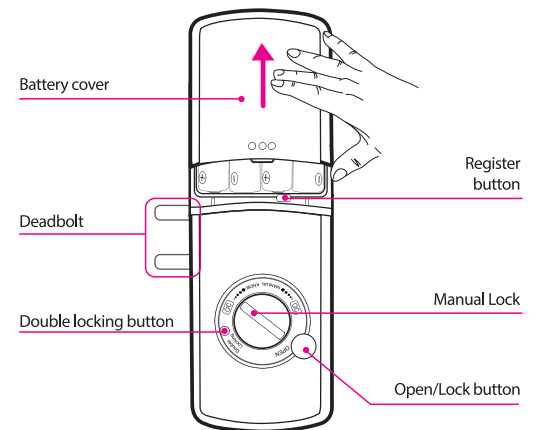

For the Emergency use: If [Open / Lock] button is not working, then just turn the manual lock by finger to open.

Press battery cover slightly and push to the direction of the arrow to open.

3

Registering and changing the password

(Up to 3 passwords can be registered)

Caution The door must be open while registering the password. Default password is 1,2,3,4.

1. Open [Battery cover] of the Back Ass'y and press [Register button] once briefly.
2. Press password(4~12 digit) on the touchpad of the Front Ass'y except [*], [#] buttons.
3. Press [*] to save.
4. To register another password, repeat No. 2 & 3.
5. Password registration is finished if you press [Register button].

Caution

1. In case of registering more than 1 password, all process should be done at a time. (Existing passwords will be deleted when registering new password)
2. When all three passwords are registered, Registration mode will be automatically end.
3. If no password is entered within 15 seconds while registering password, registration will be cancelled.

3D Password setting/release (It's not set when shipped from factory.)

This function prevents password exposure by recognizing entering time (less than 1 second & more).

- Standard password 1 2 3 4 3D Password 1 2 3 4
- ▶ **Setting** [Register button] → 1 2 → [Register button]
- ▶ **Unsetting** [Register button] → 1 3 → [Register button]

1. If you register standard password after setting 3D password, 3D password is automatically released.
2. You need to authorize with standard password in case of master password registration/deletion, fire or play.
3. If there's no motion for 15 seconds while entering, registration will be cancelled with sound.
4. When 3D password mode is released, existing password will be deleted and password will be defaulted to 1234567890.

4

Registering the digital key/smart key (for 2way only)

1. Open [Battery cover] and press [Register button] briefly.
 2. Place the smart key on the touch point of the front ass'y. (Whenever you contact it, registration is done with beep sound).
 3. Press [Register button] to complete registration.
- ※ When you register new smart key or register it again, you need to register all smart key at a time.

▶ Deleting digital key or smart key

Press [Register button] and [0] button for 5 seconds and all registered smart keys will be deleted.

Locking the door from inside

▶ When auto lock is set

Default setting is auto lock so the door will be locked automatically in 3 seconds after it's closed.

▶ When manual lock is set

Press [Open / Lock] button of Back Ass'y or turn the manual lock knob to [Locked] position to lock the door.

Locking the door from outside

▶ When auto lock is set

Default setting is auto lock so the door will be locked automatically in 3 seconds after it's closed.

▶ When manual lock is set

Touch [Touchpad] for more than 1 second and the door will be locked.

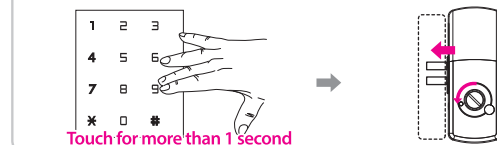

Touch for more than 1 second

2

Opening the door from inside

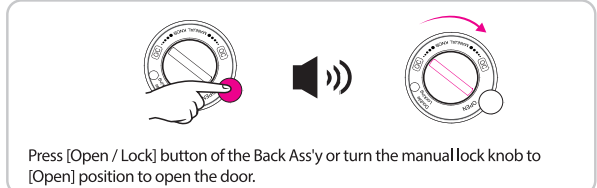

Opening the door from outside

▶ Opening the door with password

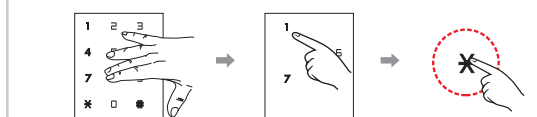

Touch [Touchpad] and press [*] button after entering password. Door opens with melody.

※ Mode will end automatically if no button is pressed within 7 seconds after touching [Touchpad].

▶ Opening the door with smart key (Type 2)

1. Place the registered smart key to [Smart key touch point].
2. After beep sound, the door will be opened.

Auto, Manual locking mode

▶ Auto locking mode (Default setting is auto locking mode.)

Open battery cover and press [Register button] → 3 → [Register button]

After the door is opened, auto locking sensor detects auto locking status. When the door is open(magnetic sensor is not working), touch [Touchpad] for more than 1 second and the door lock is locked.

Auto relocking function: When the door is not opened within 7 seconds after the lock is open, the door is relocked automatically.

▶ Manual locking mode

Open battery cover and press [Register button] → 6 → [Register button]

Attention

1. When the auto lock function is set, if the door is closed, it will be locked automatically within 3 seconds.
2. Users can unset the auto lock function to lock the door only when it's necessary.

6

Double Locking mode

When all family members are in home, this safe mode allows no one can open the door using password or digital key or smart key from outside.

▶ Setting

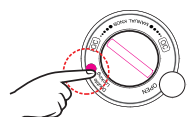

Press [Double locking] button of the Back Ass'y for more than 3 seconds and double locking is activated.

▶ Unsetting

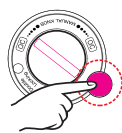

Press [Open/Lock] button of the back ass'y or open the door with [Manual Lock knob] and double locking mode is deactivated.

※ When double locking is set, the door will not be opened by password or smartkey from outside.

Double Locking unsetting from outside

This function allows the user can unset double locking mode from outside in case of setting double locking mode by mistake.

▶ Unsetting

1. While the door is locked, touch the Touchpad and enter the registered password.



2. Press the [#] button & the password. Press the [*] button again.

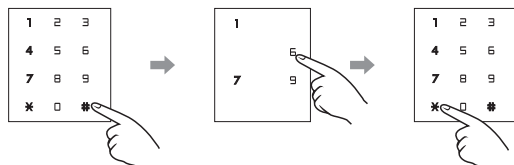

※ If the door is opened by [Open/Lock] button or manual lock knob from inside, double locking mode is released automatically.

7

High-temperature warning system

When high temperature over $70^{\circ}\text{C} \pm 10^{\circ}\text{C}$ is detected, it generates warning sound over 80dB.

▶ Releasing high-temperature warning sound

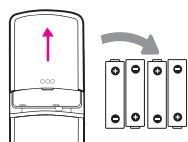

It is released when the power is reset by removing batteries.
※ It is not released when the temperature of the product is high.

Warning sound disabled if batteries are removed.



When warning sound is generated, the door opens automatically regardless of Double locking or Forced lock setting.

Trespass / Breakage alarm

▶ Operation

If there's any attempt to open the door by abnormal way such as widening the door gap, it generates 80dB warning sound with blink.

▶ Releasing warning sound

Warning sound disabled

Warning sound is disabled when registered password or digital key or smart key is entered or batteries are removed.

30 seconds LOCK function

If incorrect password or digital key or smart key is entered 3 times consecutively, warning sound is generated and all functions are disabled for 30 seconds.

Notification function of the deadbolt jam

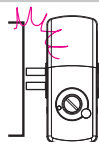

If the deadbolt is not working properly 3 times when open or lock the door, it generates melody as a warning signal.



If you keep experience warning sound or malfunction of the lock, you need to adjust the position of the lock again.

Forced lock setting/unsetting from outside

This function helps strengthen the level of security by generating powerful warning sound if someone tries to unlock the door from inside when the user leaves home for long period of time.

▶ Setting

1. Touch [Touchpad] from outside and press [#] button for 5 seconds after pressing [0] button.

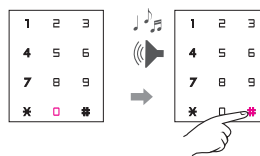

▶ Unsetting

If the user opens the door using registered password, digital key or smart key from outside, the setting is released automatically.

Entering trick numbers to prevent exposure password

If there's watchful person when the user enter password, this function allows the user can protect password by entering fake password before real password.

▶ How to use

If the password is '1234', enter fake password (random numbers) before real password, enter '1234' and the door will be opened.



After entering fake numbers (random numbers)

press '1234'

※ Fake numbers (random numbers) + real password should not exceed 20 digit.

Intrusion alert (Human hands detection system)

This function prevents intrusion by drilling a hole on the door or pressing the door open button with stick or metal wire and it makes the door open only by human hands.

▶ Setting [Register button] → 5 → [Register button]

▶ Unsetting [Register button] → 4 → [Register button]

7

Volume Control (Default setting is stage 4 of basic setting.)

The user can set the volume from silence to stage 6.

▶ Setting

[Register button] - [7] - [Register button] (Volume down)
[Register button] - [8] - [Register button] (Silence)
[Register button] - [9] - [Register button] (Volume up)

- [7] button : If pressed repeatedly, volume will be reduced gradually.
- [8] button : Silence (except warning sound)
- [9] button : If pressed repeatedly, volume will be increased gradually.

Etiquette mode



Regardless of the current sound setting, this function makes the door lock silent for 1 time when the user wants to use it quietly.

Touch [Touchpad] for 2 seconds to activate this function.

※ This is one-time function so sound will be generated from next time.

Touch for at least 2 sec.

Master password registration & deletion (Password / Smart key)

This function is for apartments and other buildings with multiple households. It may be deleted upon moving in.

▶ Master password (3D password is not available for master password.)

Registration [Register button] - [8] - [3] - [Register button] - [4 ~ 12 digit number] - [Register button]

Deletion [Register button] - [#] - [#] - [#] - [7] - [3] - [Register button] - [registered password or master password] - [Register button]

▶ Key

Registration [Register button] - [8] - [6] - [Register button] - [key contact] - [Register button]

Deletion [Register button] - [#] - [#] - [#] - [7] - [6] - [Register button] - [registered password or master password] - [Register button]

9

Battery replacement notification

When it's time to replace batteries, you will hear melody sound to let you know when open or lock the door.

When you hear this melody, open battery cover and replace all batteries with 1.5V Alkaline batteries.

- Must use general batteries, not rechargeable ones.
- Please be careful of batteries' polarity because it can cause leakage or rupture if placed wrongly.
- Must replace all old batteries with new ones, not partially. Do not use new ones with discharged ones together.
- It is designed to operate with the rated voltage 6V. If low voltage ($4.2\text{V} \pm 0.3\text{V}$) is detected, melody will be generated.
- If the door lock stops working or batteries are discharged in a short period of time after replacement, the batteries could be defective. It is required to contact the shop where the user purchased batteries and get new ones as replacement.



Caution

Emergency Power Supply

When batteries are completely discharged making it impossible to open the door, this function allows the user can open the door using 9V battery from outside.



Contact DC 9V battery to external power supply terminal and open the door using registered password or digital key or smart key.



Attention

- You can use 9V battery regardless of battery polarity.
- Please remain contact of 9V battery onto the power supply terminal so that emergency power is supplied (not rechargeable).
- Replace all discharged batteries with new ones right after emergency power is supplied.

Specification of product

Classification	Specification	
Installation	Fire proof door	Door thickness 40 ~ 50mm
Size	Front Ass'y (Front body)	71(W) x 180(H) x 18.5(D) mm
	Back Ass'y (Main body)	71(W) x 175(H) x 35 (D) mm
Open type	Password	4 ~ 12 digit (up to 3 password can be registered)
	Smart key	Up to 100 keys can be registered (3255)

* Lifetime of the batteries is based on the result of the tests by the company and is not an absolute measurement. It will vary depending on the temperature and humidity of the installed location as well as the frequency of usage and the quality of batteries.

* Function, design and composition of the product may change without any prior notice for the purpose of improving the quality.

Types of consumer damage	Content of compensation	
	Within the warranty period	After the warranty period
The product is used in normal conditions	Failure occurs within 1 month from date of purchase	Product replacement
	Failure occurs within 1 year from date of purchase	Free-of-charge repair
	Same failure occurs 4 times or more	Free-of-charge repair
Mistakes and mishandling by the user	The repair parts are not available at the main office	Product replacement
	Not the case of failure	Paid repair
Mistakes and mishandling by the user	Mistakes and mishandling by the user	Replacement after depreciation based on a fixed rate.
	Defective installation, and other reasons	

* Details of mistakes and mishandling by the user

Not the case of failure	Mistakes and mishandling by the user	Other reasons
<ul style="list-style-type: none"> • When needed to break the product due to the loss of secret code. • When the door is sagging, or installation is defective, requiring the product to be reinstalled. • Request for checking the product for possible problems while there is no specific symptom of a failure. • Problems in operation occur after the user installs the product directly. 	<ul style="list-style-type: none"> • A visit for repair is needed as there are mistakes and mishandling by the user such as mistakes in replacing batteries and unskillful use of the product. • Defective operation due to poorly inserted batteries and use of defective batteries. • Failure and breaking due to the use of the product for other purposes. • Failure and breaking caused by the user on purpose or from an external impact. 	<ul style="list-style-type: none"> • Failure and damage due to natural disasters such as fires, floods, and damage from sea water. • Penetration by water, condensation and injection of chemicals, requiring the internal circuits to be replaced, and causing failures.

Warranty

- ① The warranty period for all of the company's products is 1 year from the date of purchase indicated on the warranty certificate.
- ② Even during the warranty coverage, users need to pay (the cost for trip, technical support and parts) for some services if they are in the category of chargeable services.
- ③ User generally submit the warranty certificate or other methods that contains the installation information when needed to request a service.
- ④ If the warranty certificate is not available, users need to submit a receipt, a credit card receipt or a cash receipt instead (Except for a simple receipt)
- ⑤ If it is impossible to show the purchase date, the warranty period will be applied by taking into consideration the product's manufactured date + expiration period (6 months)
- ⑥ For products purchased outside of Korea, please consult your local distributor or reseller as warranty policies vary from country to country.