

■ Please read the manual thoroughly in order to secure your safety and to use the product properly.



## Hotel Lock Card Security Grade

### [User Card]

Card for Guest (Max 30ea)

### [Serve Card]

Card for Employee such as Housekeeper (Max 30ea)

### [Master Card]

Card for General Manager (Max 30ea)

## How to register RF Card

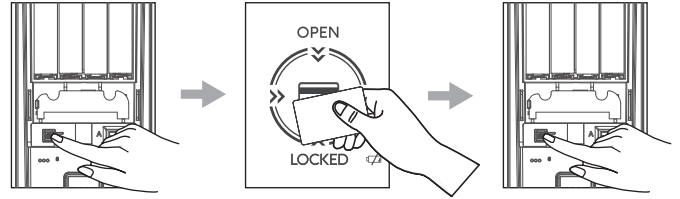

### User Card Registration

1. Open battery cover and press register Button [S].
2. Place User Card on RF Card Reader.  
※ You may register up to 30 User Cards.
3. Press register Button [S] to complete the procedure.  
※ It sounds "Beep" and blinks Red LED once in a second.

### Serve Card Registration

1. Open battery cover and press register Button [S] twice.
2. Place Serve Card on RF Card Reader.  
※ You may register up to 30 Serve Cards.
3. Press register Button [S] to complete the procedure.  
※ It sounds "Beep Beep" and blinks Red LED twice in a second.

### Master Card Registration

1. Open battery cover and press register Button [S] three times.
2. Place Master Card on RF Card Reader.  
※ You may register up to 30 Master Cards.
3. Press register Button [S] to complete the procedure.  
※ It sounds "Beep Beep Beep" and blinks Red LED three times in a second.

## How to delete RF Card

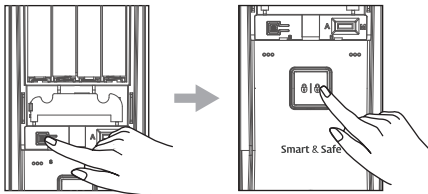

### User Card Deletion

1. Open battery cover and press register Button [S].
2. Press "010" Button for more than 2 seconds. It's deleted with "Beep" sound.

### Serve Card Deletion

1. Open battery cover and press register Button [S] twice.
2. Press "010" Button for more than 2 seconds. It's deleted with "Beep" sound.

### Master Card Deletion

1. Open battery cover and press register Button [S] three times.
2. Press "010" Button for more than 2 seconds. It's deleted with "Beep" sound.

- You should place the card within 60 seconds after press Button [S]. Otherwise the procedure will be cancelled.
- When you register maximum quantity of each grade, registration will be completed without pressing Button [S].
- When you register cards less than maximum quantity, registration will be completed though you do not press Button [S] within 60 seconds after the last card was placed. It keeps the previous cards info.
- In case of pressing Button [S] more than 4 times or pressing "010" Button shortly, the procedure will be cancelled with Beep.
- When you place the registered card again for registration, it errors with "Beep".
- When you try to register more than maximum quantity of each grade card, it errors with "Beep".
- You can register after you delete cards.

## Inside force-lock function

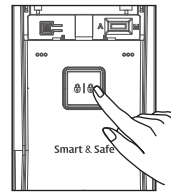

### How to turn Inside force - lock ON

Press "010" button for 3 seconds after close the door. It beeps by blinking Red LED 10 times.

### How to turn Inside force - lock OFF

Press "010" button once or open the door. It beeps by blinking Red LED 5 times.

### During Inside force - lock ON

※ Place Master Card

It opens the door with beep sound and Red LED blink.

※ Place User Card or Serve Card

It errors with beep sound and blinks Red LED 5 times.

## Auto/Manual lock setting

### Auto lock setting

1. Open battery cover and set the switch to 'Auto[A]'.  
※ It determines to auto lock while switching over to close mode after open mode.

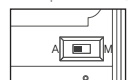

### Manual lock setting

1. Open battery cover and set the switch to 'Manual[M]'.  
※ It determines to manual lock while switching over to close mode after open mode.

- ※ To lock from outside, place RF Card on RF Card Reader.

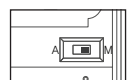

- This product cannot carry on perfect security function. You may want to install separate security system.
- All contents rights are reserved by manufacturer, and content may not be copied or reproduced in any form or by any means.
- Contents in user manual can be changed without notifying users in order to improve product quality or service.